

V1.11W offers you very useful features to customize your exercise and gain the best & accurate measurement. After exercise, you may view your fitness result by pressing the button. Please keep this manual for reference.

Item List

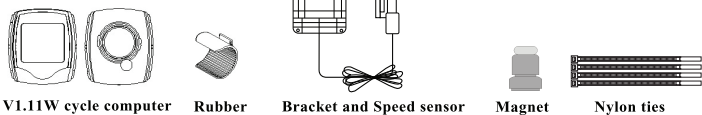

V1.11W cycle computer Rubber Bracket and Speed sensor Magnet Nylon ties

How to mount bracket

Place the cycle computer on the bracket and secure it in clockwise.

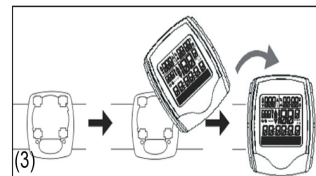

How to mount the speed sensor

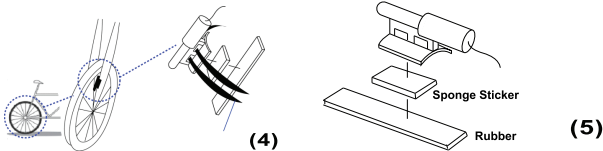

Check the position of the front fork to find the suitable point to attach the speed sensor. The speed sensor should be mount in the inner side of the chosen front fork. Use the sponge sticker and rubber to avoid slipping. Mount the sensor with nylon ties in the inner side of the chosen front fork.

Installing the Cadence & Speed Sensor

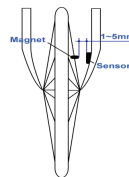
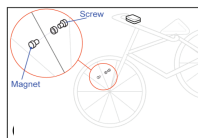

Secure the Speed Magnet on the spoke of the front wheel with screw. Make sure the magnet side faces the speed sensor zone. The maximum distance between the speed sensor and the magnet on the spoke is 5 mm. Once above items in the right position, the user may go for a ride. Note: Please make sure everything has been setup correctly before riding the bicycle.

How to Setup Cycle Computer

1) Wheel Circumference

To get the accurate result from the device for speed value or other information, the wheel size should be correct. Mark the symbol on the tire and ride one circle. Then measure the length between two points to get the circumference. Or determine the wheel circumference by the following equation:



Circumference (mm) = 2x3.14xR (inch) x2.54 (1 inch = 2.54 cm)  
R=Radius in centimeter

The cycle computer main display and Key function

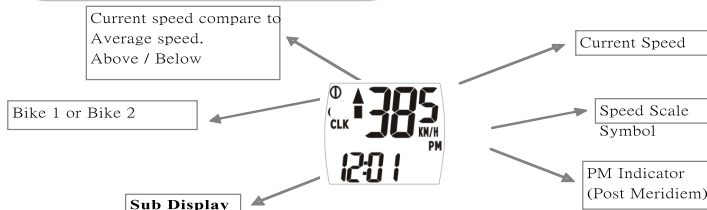

CLK MODE (Clock Mode)

How to set the Time Under CLK MODE: Press and hold "SET" key for 3 seconds to go setting clock. Press "SET" key once to adjust 12/24 hours.

Press "MODE" key to advance hour, minute and second, then press "SET" key to adjust time.

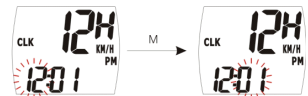

Hold "MODE" key for 3 seconds to go back to Clock Mode once the setting is finished.

TM MODE (Auto Time Mode)

Auto Timer would operate automatically when there is motion. How to reset all data Note: Press and hold the "SET" key for 3 seconds, all exercises results in display will return to zero, except odometer.



AVS MODE (Average Speed Mode)

The average speed from the beginning onwards.



MAX MODE (Maximum Speed Mode)

The maximum speed from the begging onwards



Note: If the time or distance is over the max value (9 hr: 59 min: 59 sec or Distance: 999.99km), it will not be able to measure correct average speed by showing "Err" on the display. Once the time & distance value has been reset, the average speed will show normally.

DST MODE (Distance Mode)

The trip distance accumulated from the beginning onwards.

Od1 MODE

The odo accumulated from bike 1.

OD2 MODE

The odo accumulated from bike 2.



ODO (Total Odometer Mode)

Total odometer accumulated from the beginning onwards. Note: Odometer mode will return to zero after changing new battery.



How to change speed scale, bike1&bike2, and wheel settings. ODO1 and ODO2

Under ODO Mode, hold "SET" key for 3 seconds to go to setting. Press "SET" key again to select Km/H or Mile/H, press "MODE" key to go to Bike1&Bike2 Setting, then press "SET" key to select Bike1 or Bike2.

Press "MODE" key to go to Wheel Settings. Input the correct wheel size by pressing "SET" key, the range of wheel size from 100mm to 2,999mm.

For users to input previous accumulated ODO(ODO1+ODO2) after new battery, Under Bike 1, press "MODE" key to go to ODO1 Setting. Input the previous ODO1 by pressing "SET" key, the range of ODO1 is from 1 to 99999.

Under Bike 2, press "MODE" key to go to ODO2 Setting. Input the previous ODO2 by pressing "SET" key, the range of ODO2 is from 1 to 99999.

Hold "MODE" key for 3 seconds to go back to ODO Mode.



KCAL MODE (Calorie Mode)

It displays the accumulated calories consumed from the beginning of the trip onwards. Note: This accumulated calories display will return to 0 once it has been clear under the TM MODE. KCAL MODE (Calorie Mode) It displays the accumulated calories consumed from the beginning of the trip onwards.

How to input gender, weight scale and weight



Press "SET" key for 3 seconds to go to gender setting. Press "SET" key again to select MALE or FEMALE, then press "MODE" key to go to Kg or Lb Setting.

Press "SET" key to select preferable Kg or Lb weight scale. Then, press "MODE" key to go to weight input.

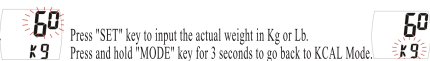

Maintenance

V1.11W cycle computer If the display contrast changes and figures become faint, it's time to replace the battery.

Note: Do not expose V1.11W computer to extremely cold or hot temperatures i.e. don't leave your unit in direct sunlight for extended periods of the time.

Sensor

Check the position of sensor and magnet periodically. For current measurement, the sensor, magnet should not get wet/ rust, otherwise it may cause function error.

Bracket/Magnet/Sensor band

The above items can be rinsed in surface fresh water or washed with a mild soap.

Battery replacement

V1.11W computer: Unscrew the back cover. Look closely at the battery. Gently remove the battery and replace it with a new battery model CR2032. the (+) side facing up.

TROUBLESHOOTING

Q1. Display is black or very light:

The battery power may be low. Try a new battery and make sure the battery is properly installed correctly. Or the unit is too hot. Please the unit in a shaded area, and it should return to normal..

Q2. The unit operates slowly or struggled:

The unit is too cold. Warm the unit, and it should return to normal.

Q3. Data in display varies enormously or show slowly:

Check your surroundings for electro magnetic or high energy interference and move away from the source of interference. The unit maybe affected by low temperature factor but it should not influence the function reading. When the temperature rise, the data reading should return to normal.

Q4. Current speed does not appear

It may be caused by the following situation: the improper distance & position between magnet and sensor. Re-set up or adjust the distance and position to an applicable range.

SPECIFICATIONS

	Computer
Operating Temperature	0°C ~ 40°C
Storage Temperature	-10°C ~ 50°C
Battery	3 volt lithium 2032 cell
Weight	30.6 grams

Timer Range: 0~9 (hour): 59 (minute): 59 (Second)  
Current Speed Range: 0~99.9 KM/ 0~62 Mile  
AVG Speed Range: 0~99.9 KM/ 0~62 Mile  
MAX Speed Range: 0~99.9 KM/ 0~62 Mile  
Trip Distance Range: 0~999.99 KM/ 0~600 Mile  
Odometer Range: 0~99999 KM/ 0~62000 Mile